

- PENDANTS: one
- CANOPY: shallow canopy 116mm (4.5") diameter
- LAMPING: 20w xenon
- LENGTH OF COAX: 3000mm (10') standard / 30550mm (100') maximum
- INSTALLATION: strain relief (pendant light site adjustable)
- MATERIALS: blown glass, braided metal coaxial cable, electrical components, brushed nickel canopy
- WEIGHT: approximately 1.3kg (3lb)
- TRANSFORMERS: direct mounted (fixture hooks directly into a junction box)

#### DESCRIPTION

The shallow canopy in this 28 variant refers to the thin canopy size. The shallow canopy is 116mm (4.5") in diameter and 7mm (0.3") deep. It is designed to cover a conventional North American junction box, which houses the transformer.

28 is an exploration of fabrication process which is part of Arbel's quest for specificity in manufacturing. Instead of designing form itself, here the intent was to design a system that produces form. Arbel developed a method that has loose parameters built into it which produce a different shape in every iteration of the fabrication procedure. Thus, every 28 made is formally different from any other 28 in existence.

#### APPLICATIONS

The 28.1 is recommended for applications where a single or small grouping of clusters are hung in a room, or many single chandeliers hung throughout.

Popular residential and commercial applications include clusters over tables in dining rooms and restaurants, accessory lighting in living rooms and baths, linear configurations over bars and kitchen islands, as well as single pendants as points of interest.

US patent #D628,740  
Canadian industrial design patent #134238

Made in Vancouver, Canada

SHALLOW CANOPY

# 28.1

Design by Omer Arbel  
PRODUCT SPECIFICATION

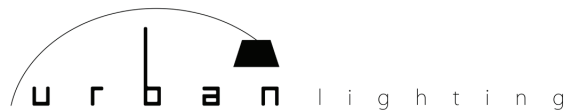

# BOCCI

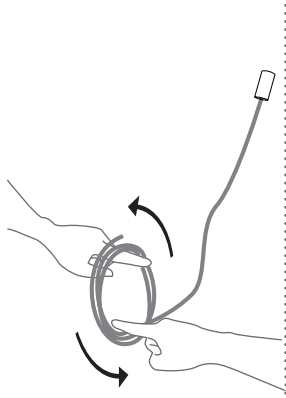

1

Very carefully uncoil the braided coaxial cable in a spool like manner. Insert your index fingers into opposite sides of the roll then rotate your fingers around each other to unroll the coaxial cable. Use patience: allow the cable to uncoil completely to avoid kinks.



2

Thread the coaxial cable through the canopy.

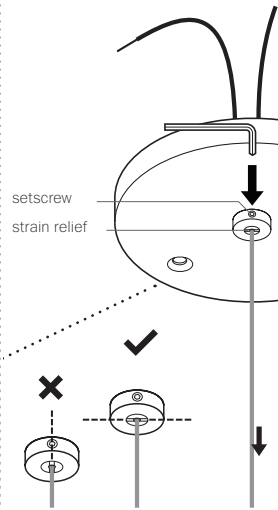

3

Determine the overall drop for the pendant fixture. Use the Allen key provided to loosen the setscrew in the canopy and gently feed the cable through the canopy until you have reached your desired drop length. Use Allen key to tighten the setscrew to hold the strain relief to secure the coaxial cable at its new length.

DO NOT OVERTIGHTEN.

Note: The strain relief is a black plastic collar around the coaxial cable. There is a single slot opening on the side of the strain relief component. It is essential that this opening is oriented at 90 degrees to set screw chamber. There can be no contact between the set screw and the cable.

- RISK OF ELECTRIC SHORT!

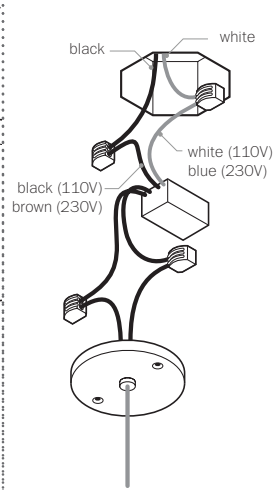

4

Connect the coaxial cable to the open slots in the terminal block on the 12V side of the transformers. Ensure that the braided outer wires are all connected to one 12V output wire and all inner insulated wires are connected to the other or a short will occur.

Once all the coaxial connections are made, lift the fixture into position and connect the line voltage to the open slot in the appropriate terminal block.

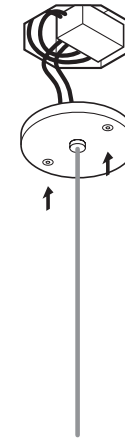

5

Tuck the transformer and wiring into the octagonal box, if available, and place canopy cover plate, lining up the fastener holes or connect directly to structural ceiling surface. Affix canopy cover with fasteners provided.

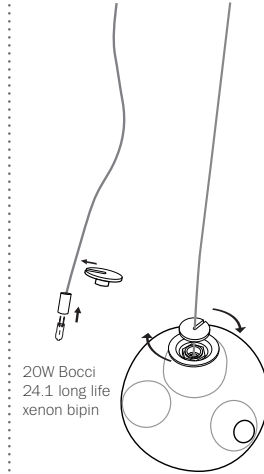

6

Bocci 24.1.2 long life bipin xenon lamps included. Plug the lamp into the socket. Do not touch the lamp with your bare hands.

Remove the center cap from 28 pendant. Install 28 pendant by sliding the center cap onto the coaxial cable gently inserting the lamp into the pendant, and then tightening the center cap connection by hand.

Do not over tighten.

Remove the protective film from the center cap after assembly.

Note: when using a dimmer for xenon, use only low voltage electronic dimmer.

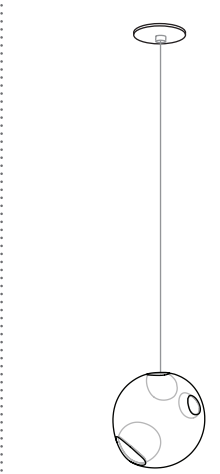

7

Clean fingerprints from glass surfaces.

Turn fixture on.

Worldwide patents issued and pending.

Made in Vancouver, Canada

Approved to UL standards by CSA



**BOCCI**

SHALLOW CANOPY

**28.1**

Design by Omer Arbel  
INSTALLATION INSTRUCTIONS

