

approx 2kg (4lb)

PENDANTS: one

CANOPY: shallow brushed nickel canopy 116 (4.5") diameter and 7mm (0.3") deep

LAMPING: 10w xenon or 1.5w LED (LED not dimmable)

LENGTH OF COAX: 3000 (10') standard / 30500 (100') maximum

INSTALLATION: strain relief (pendant light site adjustable)

MATERIALS: Cast glass, blown borosilicate glass,
braided metal coaxial cable, electrical components
brushed nickel canopy

WEIGHT: approximately 2kg (4lb)

TRANSFORMERS: transformer designed to fit into a standard junction box.
(1 transformer sent with every pendant)

DESCRIPTION

The 14.1 shallow canopy is a single 14 pendant fixture with a shallow brushed nickel canopy designed to fit over an existing junction box in which the transformer is installed. The canopy is 116mm (4.5") in diameter and 7mm (0.3") deep, which creates a subtle profile that minimizes the impact in the application surface. The pendant drop lengths on this chandelier are adjustable up to the specified maximum.

The 14.1 is an articulated, seamed cast glass sphere with a frosted cylindrical void that houses a low voltage lamp. Individual pendants are visually quite subtle, but gain tremendous strength when multiplied and clustered in large groups.

NOTES

- + Unless otherwise noted when ordering, all chandeliers will be outfitted to be xenon compatible.
- + As an alternative to the junction box transformer, Bocci recommends mounting transformers remotely in an easily accessible and hidden location for ease of long-term maintenance.

US patent # D556, 361 Worldwide patents issued and pending.
Made in Vancouver, Canada

Approved to UL standards by CSA



SHALLOW CANOPY

14.1 Design by Omer Arbel
PRODUCT SPECIFICATION

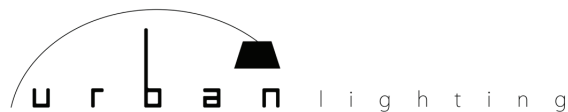

BOCCI

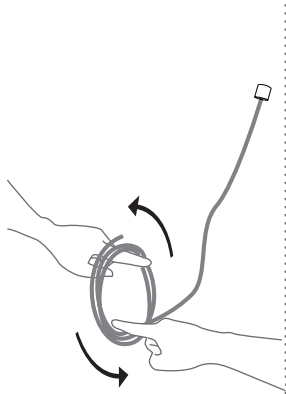

1

Very carefully uncoil the braided coaxial cable in a spool like manner. Insert your index fingers into opposite sides of the roll then rotate your fingers around each other to unroll the coaxial cable. Use patience: allow the cable to uncoil completely to avoid kinks.



2

Thread the coaxial cable through the canopy. Throughout installation be mindful not to damage the borosilicate tube inside the pendant.

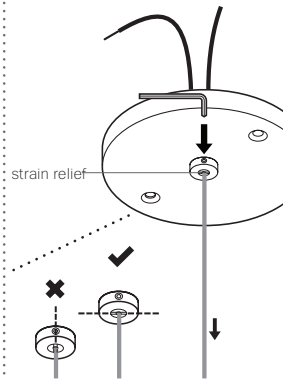

3

Determine the overall drop for the pendant fixture. Use the Allen key provided to loosen the setscrew in the canopy and gently feed the cable through the canopy until you have reached your desired drop length. Use Allen key to tighten the setscrew hold the strain relief to secure the coaxial cable at its new length. **DO NOT OVERTIGHTEN.**

Note: The strain relief is a black plastic collar around the coaxial cable. There is a single slot opening on the side of the strain relief component. It is essential that this opening is oriented at 90 degrees to set screw chamber. There can be no contact between the set screw and the cable.
- RISK OF ELECTRIC SHORT!

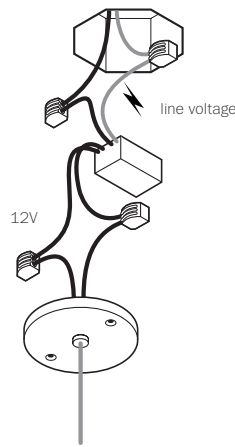

4

Xenon/LED: Connect the coaxial cable to the open slots in the terminal block on the 12V side of the transformer. Ensure that the braided outer wires are all connected to one 12V output wire and all inner insulated wires are connected to the other or a short will occur.

Once all the coaxial connections are made, lift the fixture into position and connect the line voltage to the open slot in the appropriate terminal block.

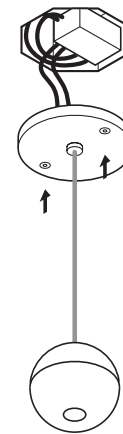

5

Tuck the transformer and wiring into the octagonal box, if available, and place canopy cover plate, lining up the fastener holes or connect directly to structural ceiling surface. Affix canopy cover with fasteners provided.

Note: It may be helpful to rest the pendant on a surface higher than its final position so that the canopy may be fastened with greater ease.

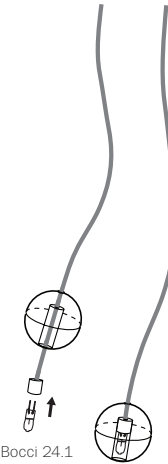

10W Bocci 24.1 long life xenon bipin or 1.5W 24.2 LED

6

Bocci 24.1 long life bipin xenon lamps included. Bocci 24.2 LED lamps optional. Lamping is transformer specific.

Plug the lamp into the socket. Do not touch the lamp with your bare hands.

Note: when using a dimmer for xenon, use only low voltage electronic dimmer to ensure the fixture works properly.



7

Clean fingerprints from glass surfaces.

Turn fixture on.

*

Worldwide patents issued and pending.

US patent # US D556,361

Made in Vancouver, Canada

Approved to UL standards by CSA



SHALLOW CANOPY

14.1

Design by Omer Arbel
INSTALLATION INSTRUCTIONS

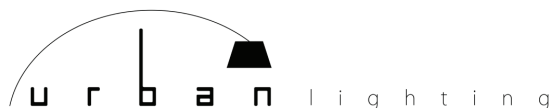

BOCCI